

PROPOSED PLOT PLAN FOR LOT _____		PLAT _____
Owner _____	Date _____	Email _____
Address _____		Telephone _____
Note: All building must comply with Sanpete County Building Codes and building permits must be obtained where required. Sanpete Building Inspector (435)835-2113. Approval by the POA does not supersede any Sanpete County requirement that may be applicable to this proposed plot plan.		

Example plot plan for a shed.
 Check county regulations for the size allowed without county permit.

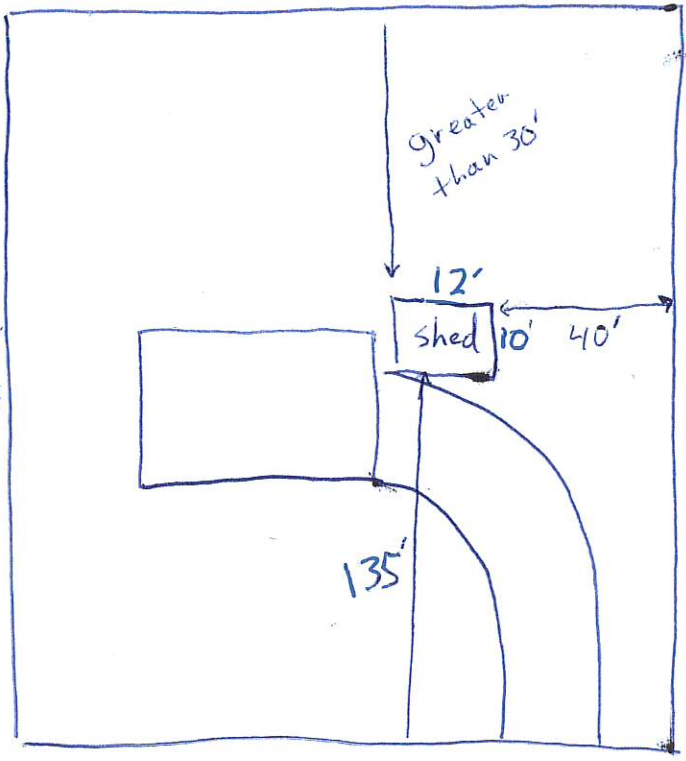

Only Single story Shed allowed

Minimum Cabin Size = Defer to Sanpete County building requirements for minimum size. Please include all measurements.

Minimum front setbacks to cabin = 66' Side yard = 30', Rear yard = 30', Driveway minimum to property line = 20' Culverts must be installed, as needed, at entrance to property to protect roads, 14" (minimum, unless otherwise approved by the Board). Culverts require final inspection by Road Committee.

When completed please submit, by email, to: indianridgepoaarchitecture@gmail.com

Note: No work, including cutting of driveways, may be done until plot plan is approved in writing.

Approved: Yes _____ No _____

Committee Signatures: 1) _____ 2) _____
 3) _____ Date _____

POA Board Signature: _____

If Required: County Permit Approval Date _____ Committee Initials _____